

John Burr

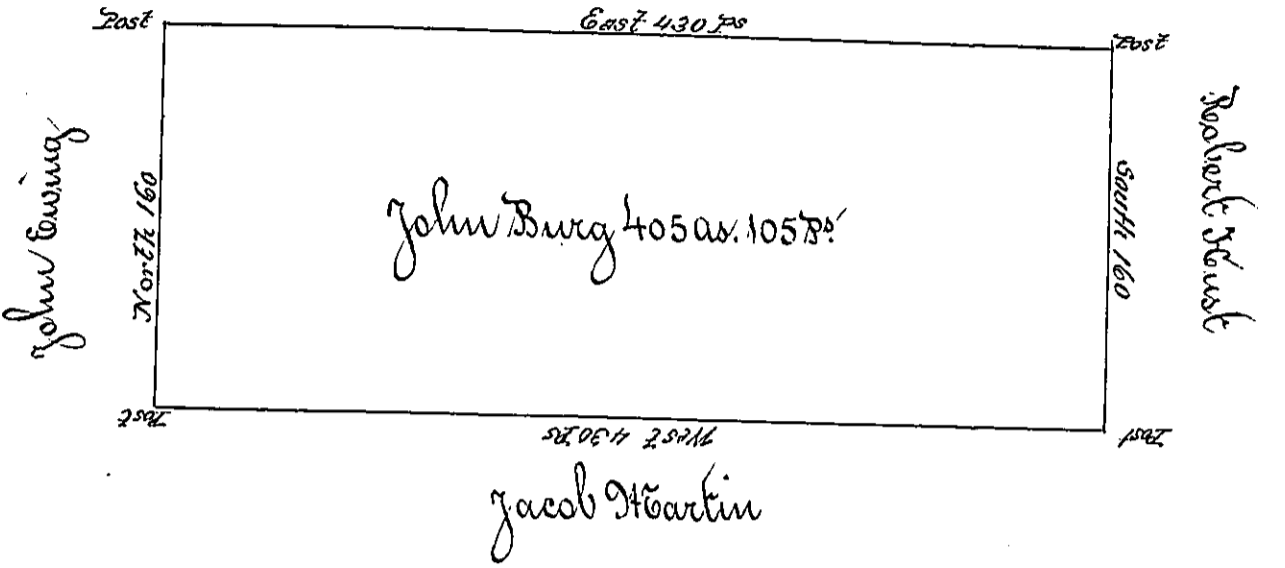

Jacob Martin

Situated on the Waters of Two Lick Creek, including some Springs, in Wheatfield Township, Westmoreland County, containing 405 acres and 105 Perches and allowance of 6 per cent for Roads by. Resurveyed for John Burg the 21<sup>st</sup> day of November 1794, on warrant dated the 3<sup>rd</sup> day of May 1793 -

To Daniel Broadhead Esq. S. G.

James Ross D. S.

IN TESTIMONY that the above is a copy of the original remaining on file in the Department of Internal Affairs of Pennsylvania, made conformably to an Act of Assembly approved the 16th day of February, 1833, I have hereunto set my Hand and caused the Seal of said Department to be affixed at Harrisburg, this Sixth day of November 1900.

*James W. Latta*  
Secretary of Internal Affairs.